

2009 FIT - ECM/PCM Replacement

Special Tools Required

- ▶ Honda Diagnostic System (HDS) tablet tester
- ▶ Honda Interface Module (HIM) and an iN workstation with the latest HDS software version
- ▶ HDS pocket tester
- ▶ GNA600 and an iN workstation with the latest HDS software version
Any one of the above updating tools can be used.

NOTE: Make sure the HDS/iN workstation has the latest HDS software version.

1. Connect the HDS to the data link connector (DLC) (A) located under the driver's side of the dashboard.
2. Turn the ignition switch to ON (II).
3. Make sure the HDS communicates with the ECM/PCM and other vehicle systems. [If it doesn't, go to the DLC circuit troubleshooting](#). If you are returning from the DLC circuit troubleshooting, skip steps [4](#) through [9](#), [19](#) through [24](#), and [27](#) through [29](#), and do these procedures after replacing the ECM/PCM:
 - [Replace the engine oil](#) and [the engine oil filter](#).
 - [Replace the ATF \(A/T\)](#).
 - [Clean the throttle body](#).
4. Select the PGM-FI system with the HDS.
5. Select the INSPECTION MENU with the HDS.
6. Select the ETCS TEST, then select the TP POSITION CHECK, and follow the screen prompts.
NOTE: If the TP POSITION CHECK indicates FAILED, continue with this procedure.
7. Select the REPLACE ECM/PCM MENU, then select READ DATA, and follow the screen prompts.
NOTE:
 - Doing this step copies (READS) the engine oil life data from the original ECM/PCM so you can later download (WRITES) it into the new ECM/PCM.
 - If READ DATA indicates FAILED, continue with this procedure.
8. A/T: Select the A/T system with the HDS.
9. A/T: Select the REPLACE TCM/PCM MENU, then READ DATA, and follow the screen prompts.
NOTE:
 - A/T: Doing this step copies (READS) the ATF life data from the original PCM so you can later download (WRITES) it into the new PCM.
 - A/T: If READ DATA indicates FAILED, continue with this procedure.
10. Jump the SCS line with the HDS.
11. Turn the ignition switch to LOCK (0).

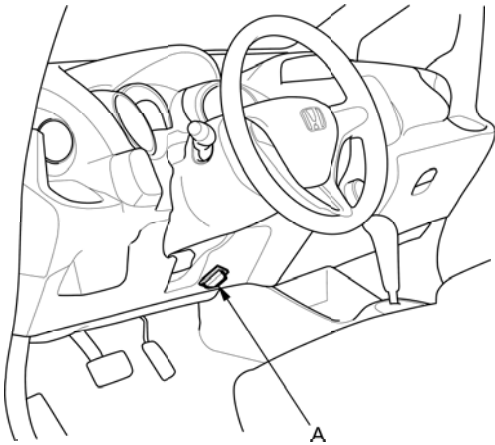

12. Remove the ECM/PCM cover (A).
13. Remove the battery holder (B), and reposition the battery away from the ECM/PCM.
NOTE: Do not disconnect the battery terminals.

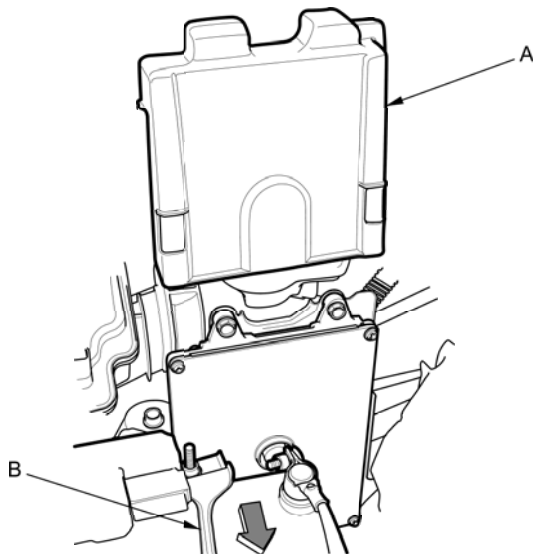

14. Remove the bolts (D), and loosen the bolt (E).
15. Disconnect ECM/PCM connectors A, B, and C, then remove the ECM/PCM (F).
NOTE: ECM/PCM connectors A, B, and C have symbols (A= \square , B= \triangle , C= \circ) embossed on them for identification.
16. Install a known-good ECM/PCM in the reverse order of removal.
17. Turn the ignition switch to ON (II).
18. Manually input the VIN to the ECM/PCM with the HDS.
NOTE: DTC P0630 (VIN Not Programmed or Mismatch) may be stored because the VIN has not been programmed into the ECM/PCM; ignore it, and continue this procedure.
19. If the READ DATA (engine oil life) failed in step [7](#), go to step [22](#) (A/T) or step [25](#) (M/T). Otherwise, go to step [20](#).
20. Select the PGM-FI system with the HDS.

21. Select the REPLACE ECM/PCM MENU, then WRITE DATA, and follow the screen prompts.
NOTE: If the WRITE DATA indicates FAILED, continue with this procedure.
22. A/T: If the READ DATA (ATF life) failed in step [8](#), go to step [25](#). Otherwise go to step [23](#).
23. A/T: Select the A/T SYSTEM with the HDS.
24. A/T: Select the REPLACE ECM/PCM MENU, then WRITE DATA, and follow the screen prompts.
NOTE: A/T: If the WRITE DATA indicates FAILED, continue with this procedure.
25. Select IMMOBI system with the HDS.
26. Enter the immobilizer ECM/PCM code that you got from the iN, and use the ECM/PCM replacement procedure in the HDS; it allows you to start the engine.
27. If the TP POSITION CHECK failed in step [6clean the throttle body](#), then go to step [28](#).
28. If the READ DATA failed in step [7](#) or the WRITE DATA failed in step [21](#), [replace the engine oil](#) and the [engine oil filter](#), then go to step [29](#) (A/T) or step [30](#) (M/T).
29. If the READ DATA failed in step [9](#) or the WRITE DATA failed in step [24](#), [replace the ATF](#), then go to step [30](#).
30. Select the PGM-FI system, and reset the ECM/PCM with the HDS.
31. [Update the ECM/PCM if it does not have the latest software.](#)
32. [Do the ECM/PCM idle learn procedure.](#)
33. [Do the CKP pattern learn procedure.](#)

